

Manchester Road

New Build
Construction Compound

IMPORTANT NOTICE

ALL USERS of the school site should note:

- side entrance gates will not be unlocked until the appropriate path has been gritted
- only authorised snow clearance personnel are permitted to utilise the indicated pathways until the completion of gritting (indicated by the timings shown)
- if heavy snowfall occurs the front entrance of the school will be cleared first and **further guidance will be posted at the main entrance to reception**

During adverse weather conditions all users of this site must exercise due care and attention when moving around the site, including routes/areas which may have been gritted.

Snow Clearance Routes	Projected Clearance Times
	6.30—7.00 am
	7.00—7.30 am
	7.30—8.00 am

Astroturf

Playing Field

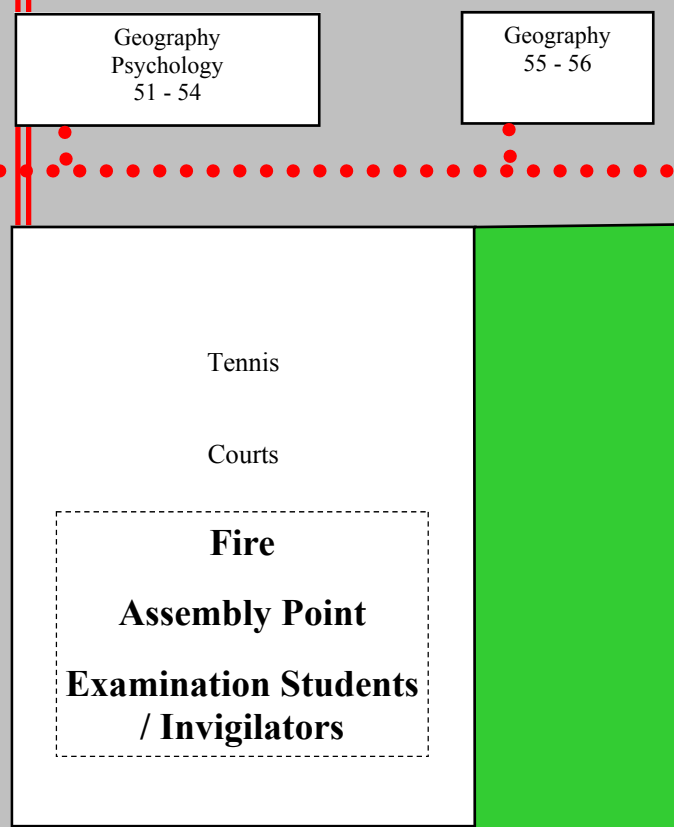
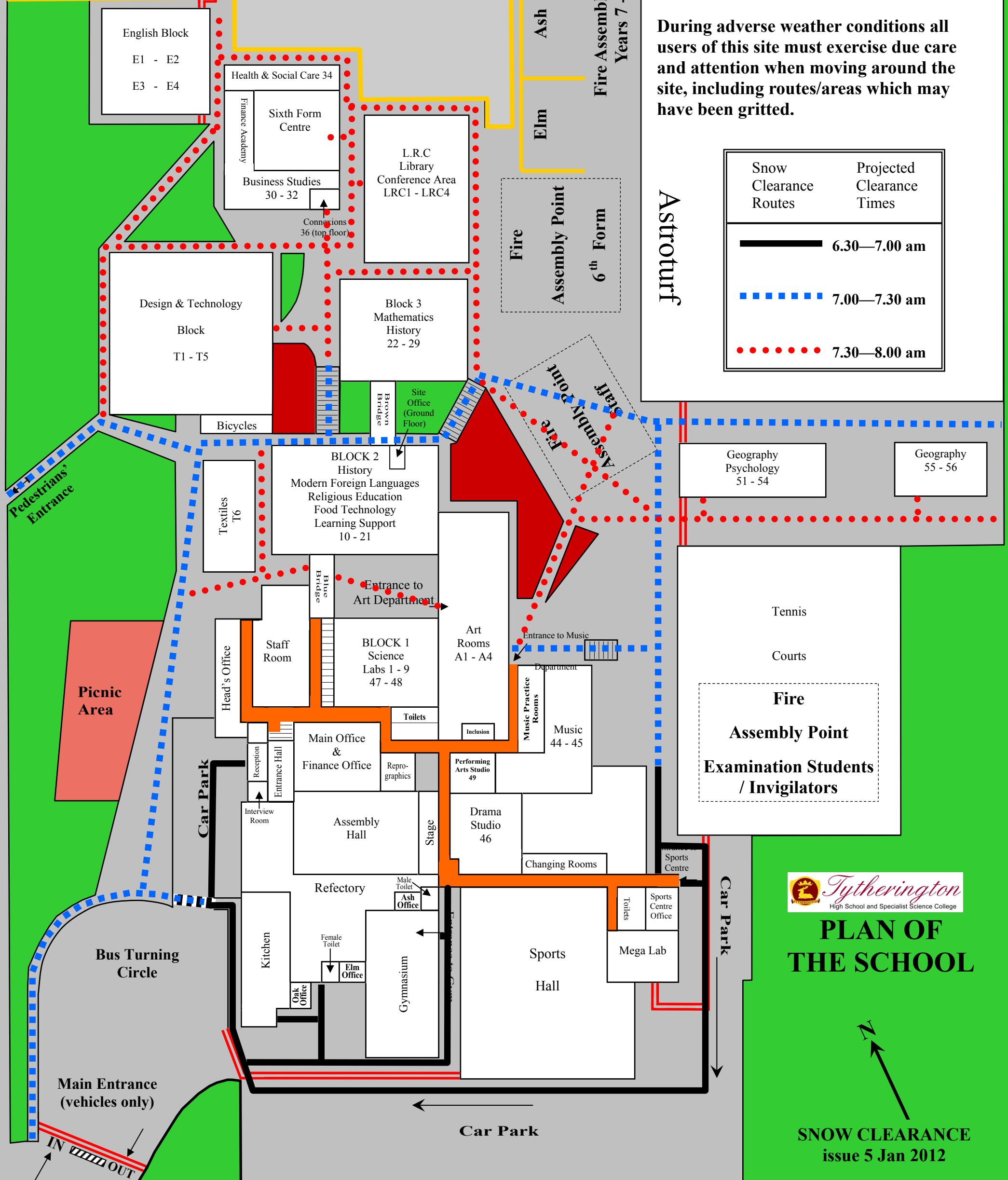

PLAN OF THE SCHOOL



SNOW CLEARANCE
issue 5 Jan 2012